

180° HOOK

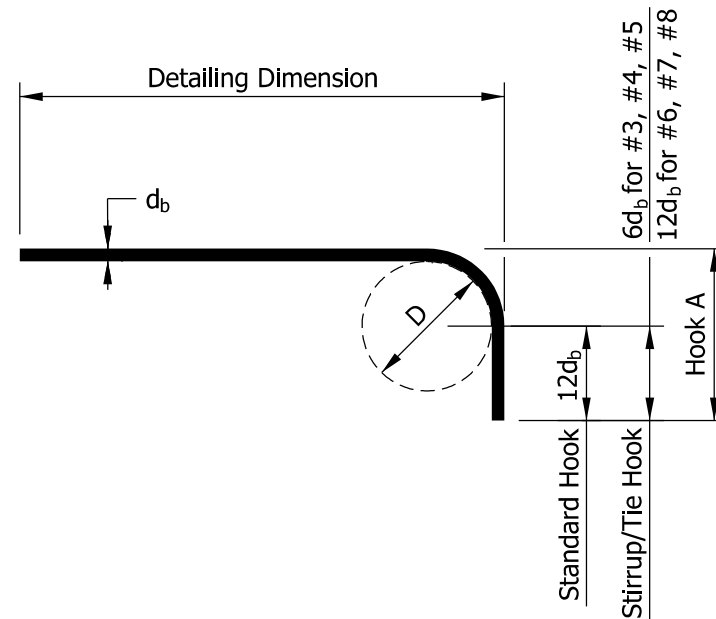

90° HOOK

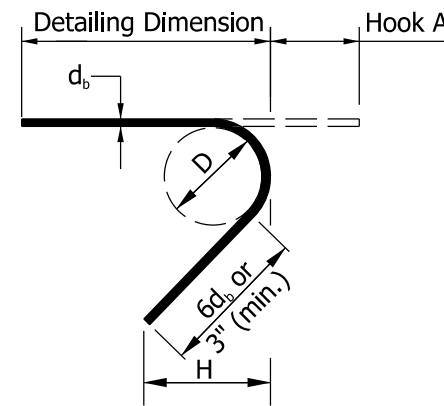

135° SEISMIC HOOK

NOTES:

1. All dimensions on reinforcing bar bending diagrams shall be measured out-to-out of bars.
2. All dimensions on reinforcing bar details shall be measured on centerlines of bars, except where cover or cl. is indicated.
3. Bent bars will be given a numeric bar mark, e.g., 588. The last two digits, e.g., 88, indicate the mark. The characters preceding the last two digits, e.g., 5, indicate the size of the bar.
4. Straight bars will be designated by size and length.
5. Standard size hooks shown shall be used on all hooked bars unless noted.
6. See the plans for lap and embedment lengths.
7. This drawing is consistent with the ACI 318-14 and CRSI *Manual of Standard Practice*.

ACI = American Concrete Institute
 CRSI = Concrete Reinforcing Steel Institute

STANDARD END HOOKS				
BAR SIZE	D	180° HOOK		90° HOOK
		HOOK A	J	HOOK A
#3	2 1/4"	5"	3"	6"
#4	3"	6"	4"	8"
#5	3 3/4"	7"	5"	10"
#6	4 1/2"	8"	6"	1'-0"
#7	5 1/4"	10"	7"	1'-2"
#8	6"	11"	8"	1'-4"
#9	9 1/2"	1'-3"	11 3/4"	1'-7"
#10	10 3/4"	1'-5"	1'-1 1/4"	1'-10"
#11	12"	1'-7"	1'-2 3/4"	2'-0"
#14	18 1/4"	2'-3"	1'-9 3/4"	2'-7"
#18	24"	3'-0"	2'-4 1/2"	3'-5"

STIRRUP / SEISMIC HOOKS				
BAR SIZE	D	135° SEISMIC HOOK		90° HOOK
		HOOK A	H*	HOOK A
#3	1 1/2"	4 1/4"	3"	4"
#4	2"	4 1/2"	3"	4 1/2"
#5	2 1/2"	5 1/2"	3 3/4"	6"
#6	4 1/2"	8"	4 1/2"	1'-0"
#7	5 1/4"	9"	5 1/4"	1'-2"
#8	6"	10 1/2"	6"	1'-4"

* H dimension is approximate

INDIANA DEPARTMENT OF TRANSPORTATION

BAR BENDING DETAILS

EFFECTIVE FOR LETTINGS ON OR AFTER 12-01-21

RECURRING PLAN DETAIL NO. 703-B-316d